



## MEDICAL & PHARMACEUTICAL ROBOT

Designed specifically for medical and pharmaceutical applications, the new high speed MCR04N Robot meets the healthcare industry's processing equipment specifications for accuracy, consistency and cleanliness. Its features make the MCR04N Robot ideal for a wide range of assembly, dispensing, inspection and material handling applications within the healthcare industry.

# MCR04N

<b>Payload</b>	4 kg
<b>Horizontal Reach</b>	506 mm
<b>Vertical Reach</b>	938 mm
<b>Repeatability</b>	± 0.1 mm
<b>Maximum Speed</b>	5,000 mm/s

### Medical & Pharmaceutical Applications

- Assembly
- Dispensing
- Inspection
- Material Handling



## CLEANROOM CLASSIFICATION

The new MCR04N Robot was designed for cleanroom environments and meets Class 100 of the US FED STD 209E cleanroom standards. A Class 100 cleanroom maintains less than one hundred particles larger than 0.5 microns in each cubic foot of air space. It is equivalent to ISO Class 5 cleanroom.

## SANITARY FEATURES

Built for medical and pharmaceutical applications in non-sterile areas, the streamlined design of the MCR04N Robot features a smooth surface, high performance seals, and a chemical resistant epoxy paint finish for easy cleaning to help prevent contamination.

## HOLLOW WRIST

The through-arm cable and tube technology of the MCR04N Robot minimizes potential interference with other processing and manufacturing equipment.

## COMPACT BODY

The MCR04N Robot is a fully functional 6-axis robot complete with all the features of larger robots, yet weighs a mere 25 kg. Its compact size is ideal for narrow or confined spaces and also allows for the robot to be mounted directly to a machine or table top.

## MOTION RANGE & DIMENSIONS

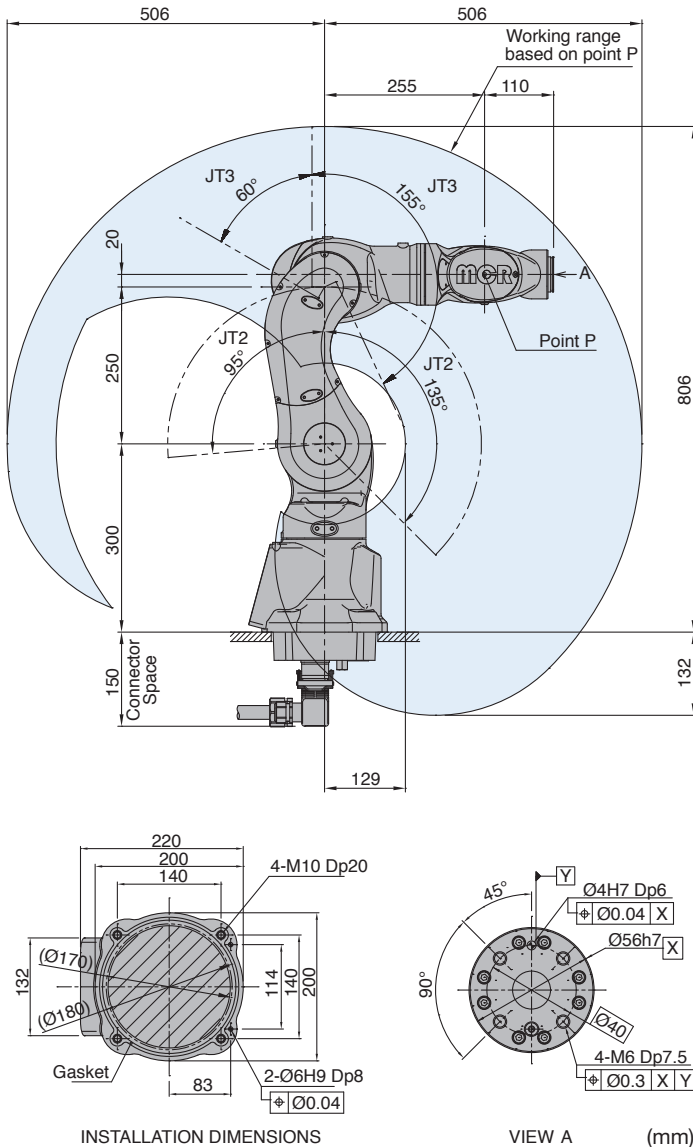

**Note:** Detailed drawings are available upon request.

## MCR04N SPECIFICATIONS

Type	Articulated		
Degrees of Freedom	6 axes		
Payload	4 kg		
Horizontal Reach	506 mm		
Vertical Reach	938 mm		
Repeatability	±0.10 mm		
Maximum Speed	5,000 mm/s		
Work Envelope (degrees) & Maximum Speed (degrees/s)	Axis	Motion Range	Maximum Speed
	JT1	±180°	175°/s
	JT2	+135° ~ - 95°	180°/s
	JT3	+60° ~ -155°	225°/s
	JT4	±270°	700°/s
	JT5	±120°	500°/s
	JT6	±270°	350°/s
Wrist Load Capacity	Axis	Maximum Torque	Moment of Inertia
	JT4	8.5 N·m	0.20 kg·m²
	JT5	8.5 N·m	0.20 kg·m²
	JT6	4.0 N·m	0.10 kg·m²
Motor(s)	Brushless AC Servomotor		
Brakes	All axes		
Mass	25 kg (excluding Options)		
Body Color	Epoxy paint (ampule white)		
Installation	Floor, ceiling		
Environmental Conditions	Temperature		10 ~ 35° C
	Humidity		35 ~ 85 % (no dew, nor frost allowed)
Protection Classification	Wrist: IP67	Base: IP65	* Equivalent
Cleanroom Classification	ISO Class 5 (Fed. Std. Class 100)		
Controller	E77 (see E Controller data sheet for specifications)		

Simple  friendly

Assembly • Cutting • Dispensing • Grinding • Handling • Inspection • Packaging • Painting • Palletizing • Polishing • Tending • Welding

### Kawasaki Robotics (USA), Inc.

#### United States

28140 Lakeview Drive  
Wixom, Michigan 48393  
Phone (248) 446-4100  
Email sales@kri-us.com

#### Canada

Phone (905) 465-0880

#### Mexico

Phone (52) 33-3110-1895

[www.kawasakirobotics.com](http://www.kawasakirobotics.com)

MCR04N - REV08/13

© Kawasaki Robotics (USA), Inc. All rights reserved.  
Technical specifications subject to change without notice.